

Thank you for choosing the Elitech electronic refrigerant scale. Please read this manual thoroughly before use, especially the "Warning" section. Keep the manual with the scale for further consultation.

Specifications

Maximum capacity	100kg (220lb)
Resolution	5g
Accuracy	±0.05% rdg+10g
Battery	5 AAA batteries
Battery life	35 hours
Operating temperature	-10°C~40°C
Storage temperature	-15°C~50°C
Temperature fluctuation range	5°C/h
Relative humidity	50~85% RH
Dimensions	271 x 271 x 74 mm



Display

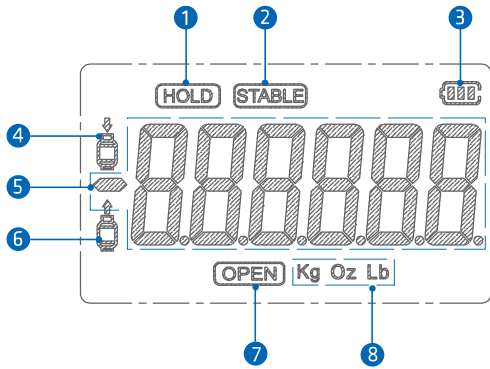

① Current Weight Locked	⑤ Weight
② Stable Status	⑥ Charging Status
③ Battery Level	⑦ Charging Valve Open
④ Recovery Status	⑧ Current Unit

Buttons

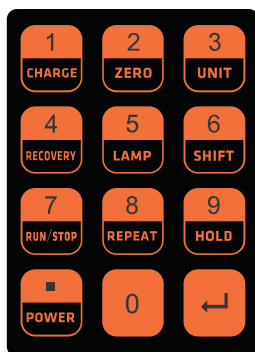

POWER	When charging or recovery is not in progress, press this button to turn on the scale; hold it for 3 seconds to turn off the scale.
ZERO	Press to zero the reading.
UNIT	Press to switch between kg, oz and lb.

LAMP	Press to turn on the blue backlight. It will be automatically off after 10 seconds. Hold the button for 3 seconds until the buzzer beeps once, the backlight will be always on; press this button again to turn it off.
CHARGE	Press to set charging value.
RECOVERY	Press to set recovery value.
RUN/STOP	Press to close or open the charging valve immediately.
REPEAT	Press to repeat the last charging or recovery command.
HOLD	Press to lock current weight.
←	Press to confirm settings. After setting the charging/recovery value, press this button to enter charging/recovery status. If the value is incorrect, press and hold the button for 3 seconds to exit settings. During charging/recovery process, press this button to stop the process and enter weighing status.

Quick Start

1. Install 5 AAA alkaline batteries into the hand-held remote.
2. Place the platform on hard and flat floor.
3. Press **POWER** button on the remote to turn it on.
4. Press **UNIT** button to select a desired unit.
5. Press **ZERO** button to zero the reading.
6. Place the object on the platform, read the weight when the icon **STABLE** is displayed stably.
7. Charge: Press **CHARGE** button and set the charging value, then press **←** button to confirm, the charging process starts.
8. Recover: Press **RECOVERY** button and set the recovery value, then press **←** button to confirm, the recovery process starts.
9. Press **RUN/STOP** button to open the charging valve (icon **OPEN** always on) or close it (icon **OPEN** off).
10. Press **HOLD** button to lock the current weight (icon **HOLD** off).

Function & Operation

Weighing

1. Take out the refrigerant scale from the carrying case and place the platform on hard and flat floor.
2. Take out the remote from the back of the scale.
3. Press **POWER** button on the remote to turn it on. Wait until the self-test finishes and buzzer beeps.

4. Press **[UNIT]** button to switch units between kg, oz and lb.
5. Press **[ZERO]** button to zero the reading.
6. Place the refrigerant cylinder in the center of the platform and zero it again; then the screen will only display the weight of the refrigerant.
7. Press **[LOCK]** button to lock the current weight, which will remain unchanged.

Charging / Recovery

1. Connect the aviation plug female connector of the charging valve to the male connector of the platform according to their notch position.
2. Connect the refrigerant hose according to the arrow direction on the charging valve housing.
3. Charge: Press **[CHARGE]** button to enter the charging interface, set the charging value by using the number buttons; then press **[ENTER]** button to confirm and the charging valve will be open. When it reaches the set charging value, it will close automatically and alert with beep sound; Press any button to exit alarm at this moment.

If the value is set incorrectly, press and hold **[ESC]** button to exit current status and repeat the operation above.

When the platform detects weight increasing, a "-" sign will show on the left of the remote screen. If the weight is less than -0.2kg, it means an error occurs during the charging process, then the charging valve will close automatically, **[OPEN]** icon will be off and the recovery process ends. The scale enters the normal weighing status.

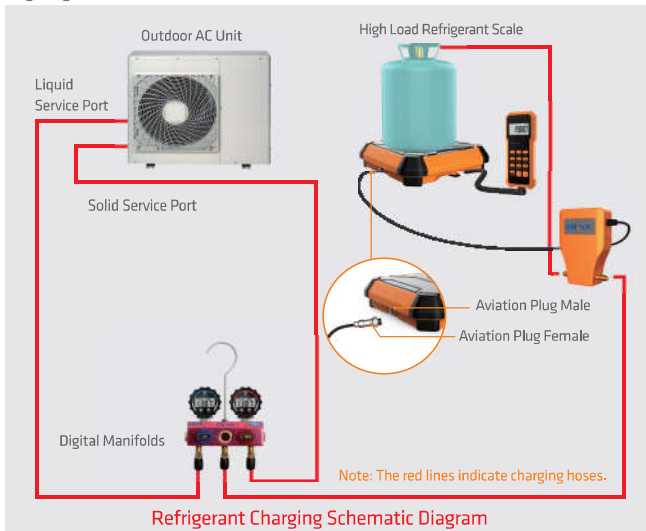

4. Recover: Press **[RECOVER]** button to enter the recovery interface, set the required recovery value by using the number buttons; then press **[ENTER]** button to confirm and the charging valve will be open. When it reaches the set recovery value, it will close automatically and alert with beep sound; Press any button to exit alarm at this moment.

If the value is set incorrectly, press and hold **[ESC]** button to exit current status and repeat the operation above.

When the platform detects weight decreasing, the value displayed on the remote screen will increase; If the weight is 0.2kg greater than the set recovery value, it means an error occurs during recovery, then the charging valve will close automatically, **[OPEN]** icon will be off and the recovery process ends. The scale enters the normal weighing status.

5. After completing a charging/recovery process, simply press **[ZERO]** button to repeat the last charging/recovery operation without re-setting the value again.
 6. Press **[OPEN]** button to open or close the charging valve immediately.
- Note: The operation above is based on measurement unit kg.

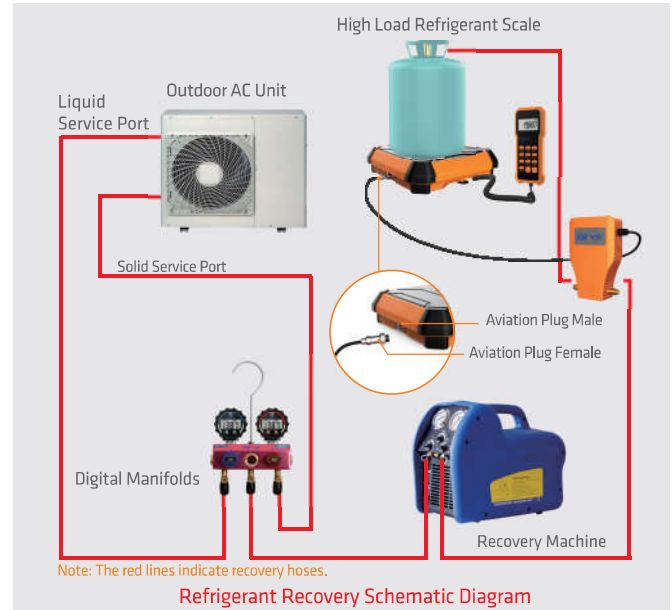

Overload Detection

If the weight exceeds the maximum capacity (100kg), the remote will display **FULL** and the buzzer will beep to indicate the alarm. Do not load an object that weighs more than 100kg onto the platform to avoid damages to the platform and sensor.

Battery Indication

When the battery voltage is extremely low, the battery indicator icon will blink and the LCD may display unstably. Please replace the batteries in time so that you can use the scale normally.

Other Functions

Self-test within 2 seconds after power-on.

Tare function applies to full weighing range.

Auto OFF: The scale will be automatically off if the weight remains unchanged for 10 minutes.

Warning

- ⚠ Please use the scale in specified environment to avoid error or damage to the sensor.
- ⚠ Please do not use chemical solvent or corrosive liquid to clean the platform.
- ⚠ Please do not disassemble the platform to avoid big weighing error.
- ⚠ Please do not pull the coiled cable hard to avoid increasing measurement errors or even damage to the sensor.
- ⚠ Remove the batteries if the scale is not to be used for a long time in case the leakage corrodes it.
- ⚠ The batteries included are not rechargeable. Please do not charge them.

What's Included

- SRC-500 Refrigerant Scale x 1
- Charging Valve x 1
- Nylon Carrying Case x 1
- AAA alkaline battery x 5
- User Manual x 1